

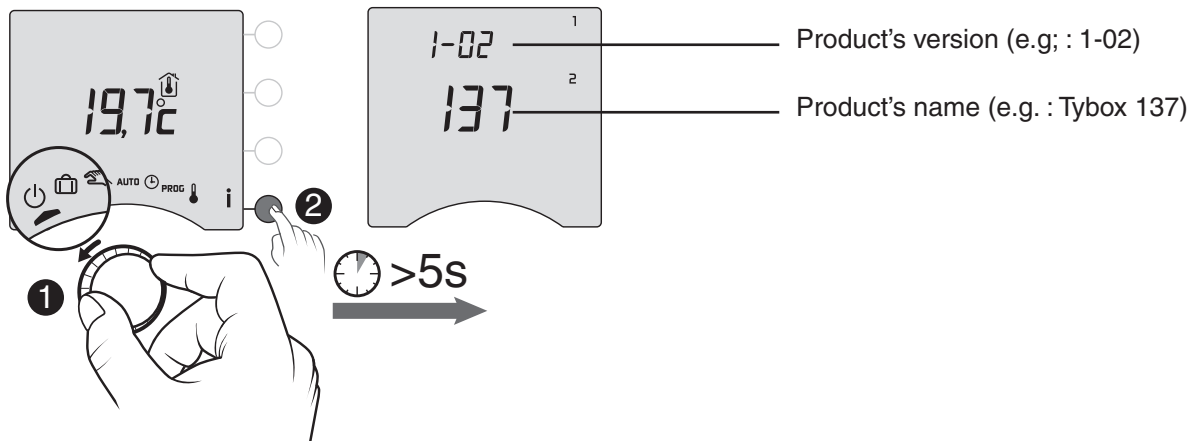

The 2-17 menu is not available for the 1-02 and 1-03 versions.

### To know your product's version :



Turn the selector dial to , then press the **i** button for 5 seconds.

To exit the mode, turn the selector dial to another mode.

**TYBOX 137 - 237**



www.deltadore.com

> 5s Press time

Room temperature

Set-point temperature

**PROG x1** Daily programming

**PROG 5 + 2** 2 daily programs (week + week-end)

**PROG x7** Weekly programming

Important product information (4)

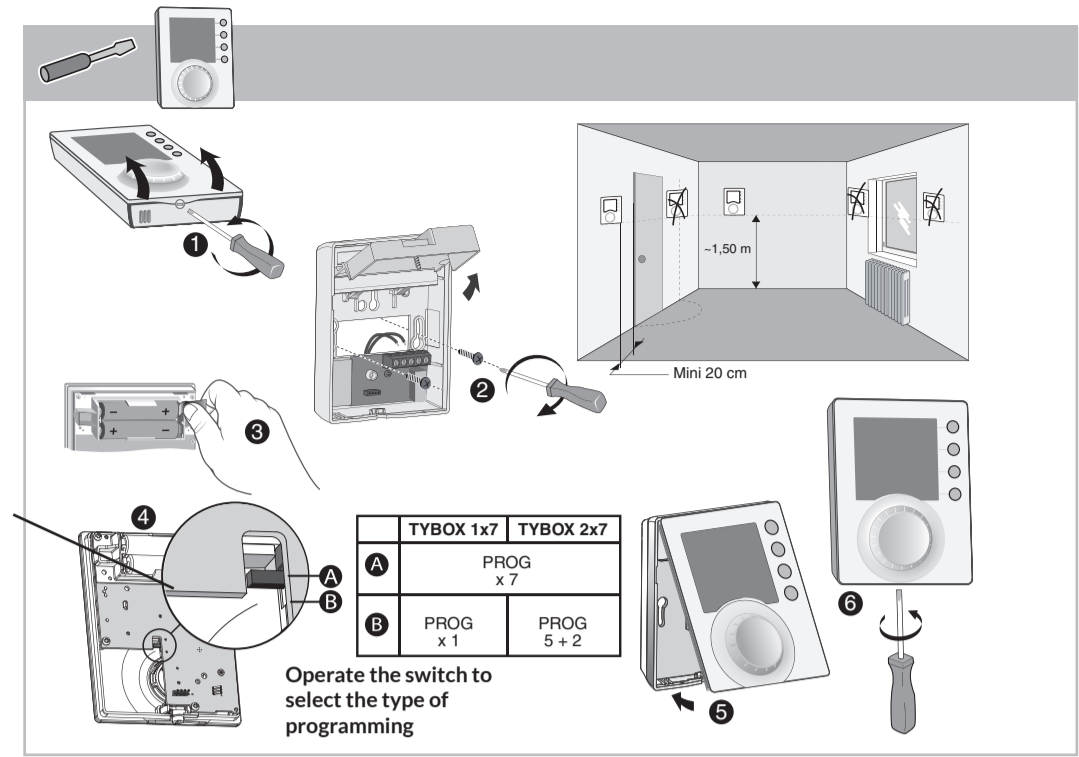

	2 x 1,5V LR03 - AAA Alkaline	230 V~ 50 Hz +/-10% 0,5 VA
	868 MHz -> 868.6 MHz (EN 300 220) - 100 -> 300 m Maximum wireless power < 10 mW - Category 2 receiver	
	/	5 A max., 230V~ (Type 1.C)
°C	-5°C / +40°C	
	80 x 103 x 25 mm	54 x 102 x 20 mm
	IP 30	

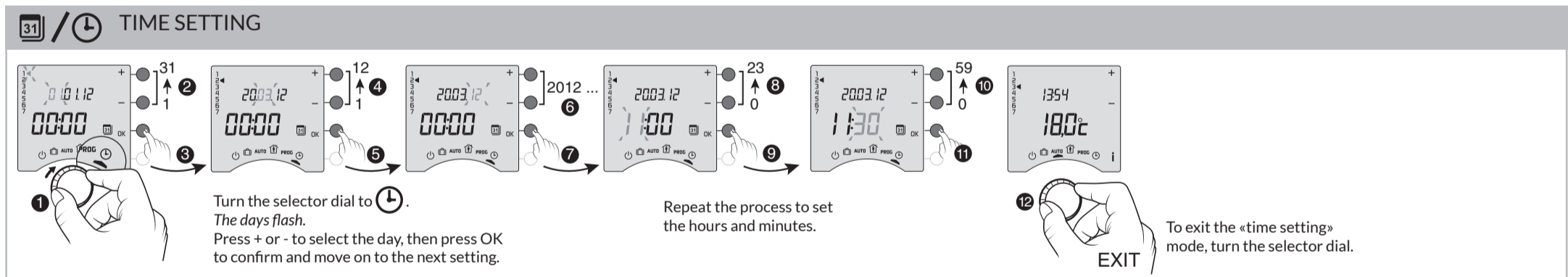
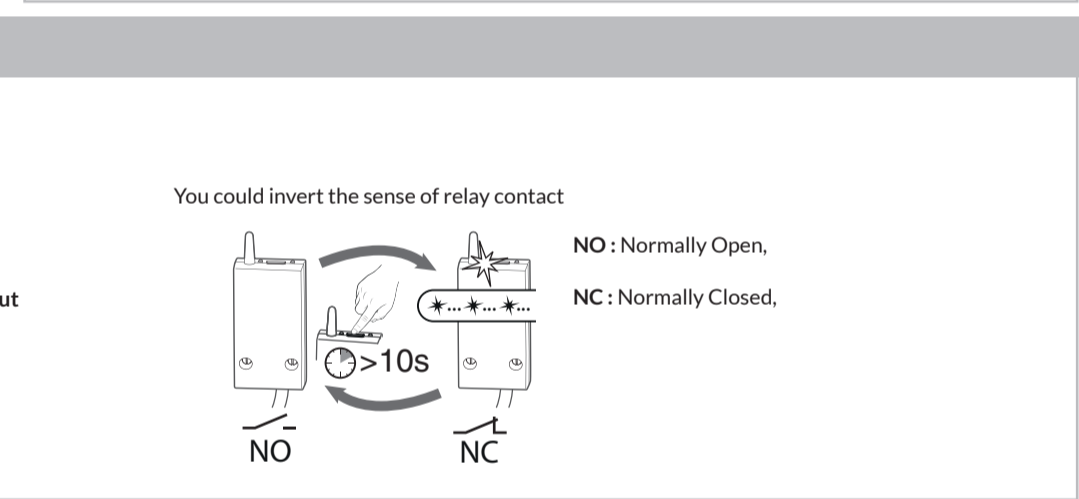
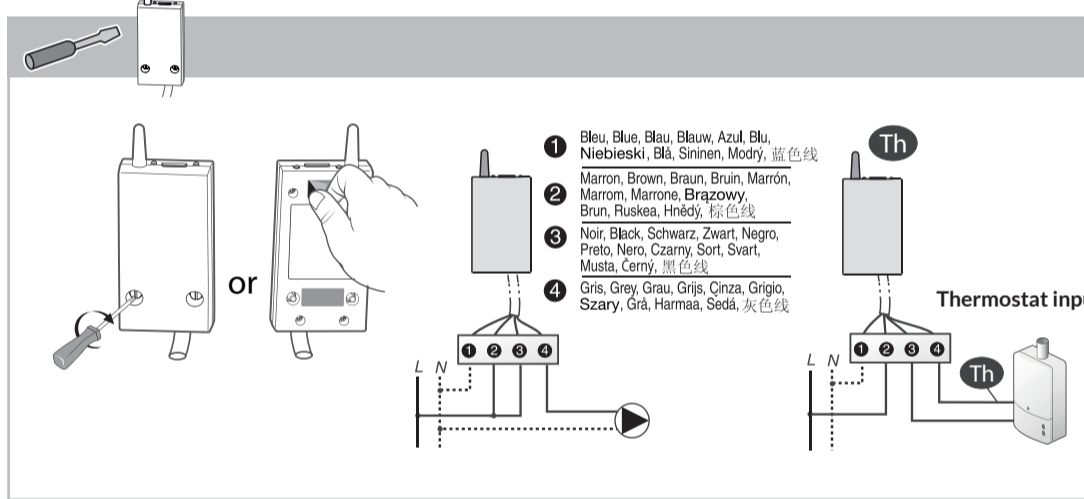
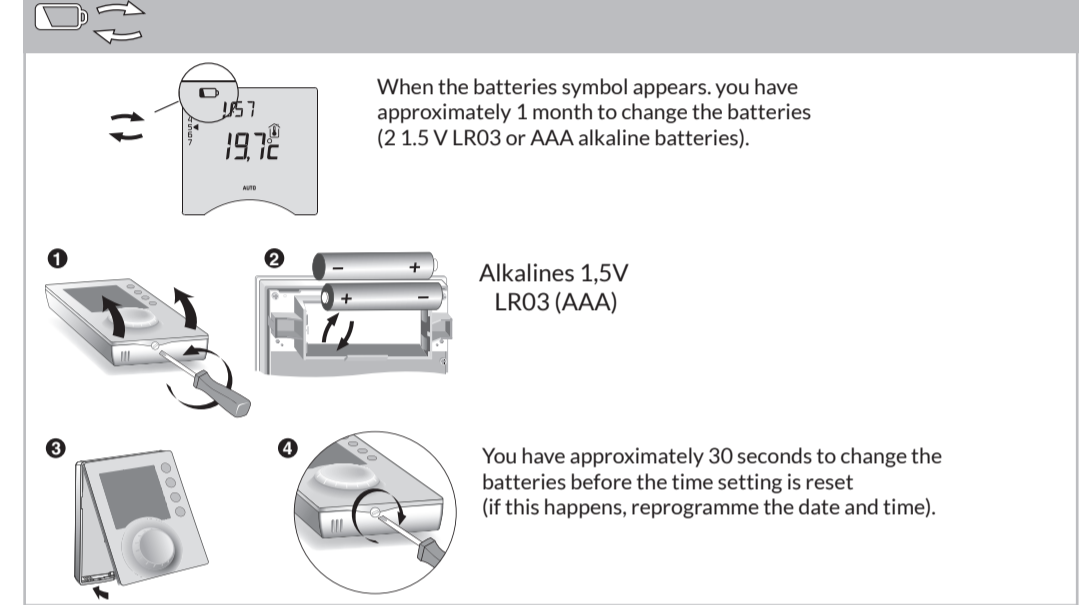

**⚙️ MENU 1**

1 Press button 1, then press the i button for 5 seconds.

2 To change the different settings, press the + or - buttons, then press the OK button to confirm and move on to the next setting.

10 To exit the mode, turn the selector dial to another mode.

1-02 Length of a programme stage	Prog	←60', 30', 15'	TYBOX 137	TYBOX 237	TYBOX 337
	0		X		
	1	60 min.			
	2	30 min.			

1-08		TYBOX 137	TYBOX 237	TYBOX 337
	0	X		
	1	Comfort regulated by TYBOX		

1-09		TYBOX 1X7	TYBOX 2X7
	0	X	X
	1	Anti-seizing on (circulator pump ON: 1 minute / 24h)	

For electrical or hot-water heating systems with thermostatic valves, the thermostat for each radiator or convector may be adjusted to give a comfortable temperature. In this case, the TYBOX only regulates the Economy and Frost-Protection temperatures.

## MENU 2

<b>2-01</b> Permission to change Programme and settings		TYBOX 137	TYBOX 237	TYBOX 337
		X	X	X
0: Modifications permitted to programme and settings	0	: 5°C <  < 30°C : 5°C <  < 16°C		
1: Modifications to programme not permitted and adjustment of settings limited. Tybox 1x7 : Comfort setting limited between 16 and 22°C. Tybox 2x7 : +/- 3°C +/- 3°C either side of the last setting.	1	16°C <  < 22°C 13°C <  < 19°C  +/- 3°C 5°C <  < 11°C		
		PROG		

<b>2-02</b> Measured temperature correction (-5°C à +5°C par pas de 0,1°C).		TYBOX 137	TYBOX 237	TYBOX 337
		X	X	X
Example: If the temperature displayed on the device is 19°C and the observed temperature is 20°C, adjust the temperature by +1°C, then confirm by pressing OK.		-5°C <  < +5°C Before changing this setting, the device must have been in operation for at least 2 hours.		

<b>2-04</b> Temperature displayed in AUTO mode		TYBOX 137	TYBOX 237	TYBOX 337
		X		
0: Continuous display of the temperature setting. In this case, press the i button to display the room temperature	0			
1: Continuous display of the room temperature. In this case, press the i button to display the temperature setting	1			

<b>2-05</b> Time display mode 12h-24h		TYBOX 137	TYBOX 237	TYBOX 337
		X	X	X
0	24h			
1	12h			

<b>2-06</b> Automatic time change (summer/winter time)		TYBOX 137	TYBOX 237	TYBOX 337
		X	X	X
0				
1				

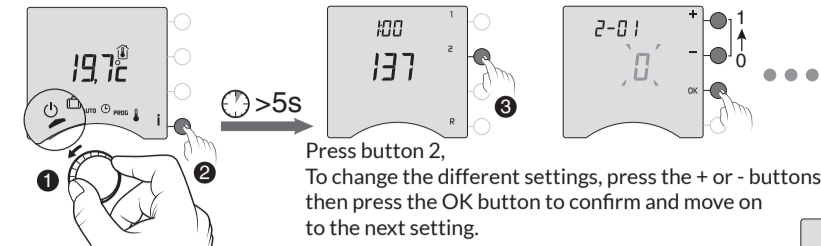

Turn the selector dial to , then press the **i** button for 5 seconds.

Press button 2, To change the different settings, press the + or - buttons, then press the OK button to confirm and move on to the next setting.

To exit the mode, turn the selector dial to another mode

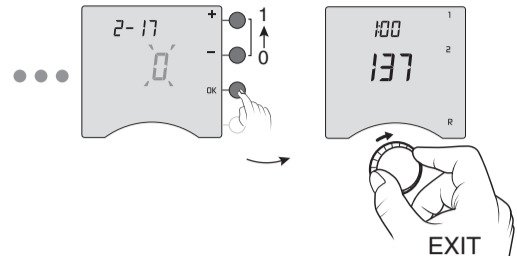

<b>2-07</b> Time before boiler maintenance (0 to 365 days)		TYBOX 1X7	TYBOX 2X7
		X	X
Reprogramme after each maintenance operation		--- (0) to 365 days (0) to 365 days	

<b>2-08</b> Control time base If you choose an «on/off» type setting, you can adjust the hysteresis (or differential) via menu 2-11		TYBOX 1X7	TYBOX 2X7
		X	X
	15	Minutes	
	30	Minutes	
	45	Minutes	
	60	Minutes	
	TOR	Tout ou rien / On-Off	

<b>2-11 (2-08 = TOR)</b>	0,2°C <  Hysteresis < 2°C
	0,4°C

<b>2-12</b> Transmitter present		TYBOX 1X7	TYBOX 2X7
			X
0	No		
1	Yes		

<b>2-17</b> Reset operating counter hours of the boiler		TYBOX 1X7	TYBOX 2X7
		X	X
0	No		
1	Yes		

<b>2-13</b> (2-12 = 1)	: 5°C -> 30°C	19°C
<b>2-14</b> (2-12 = 1)	: 5°C -> 30°C	16°C

## RESET

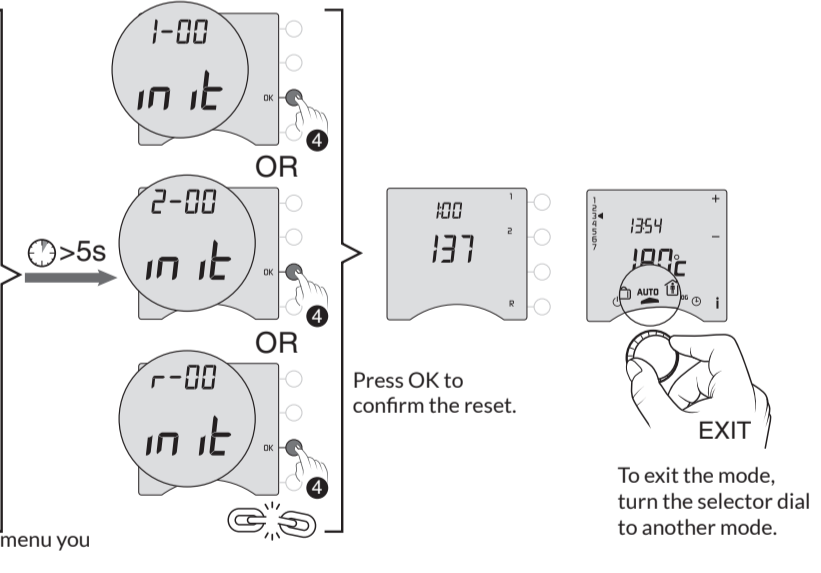
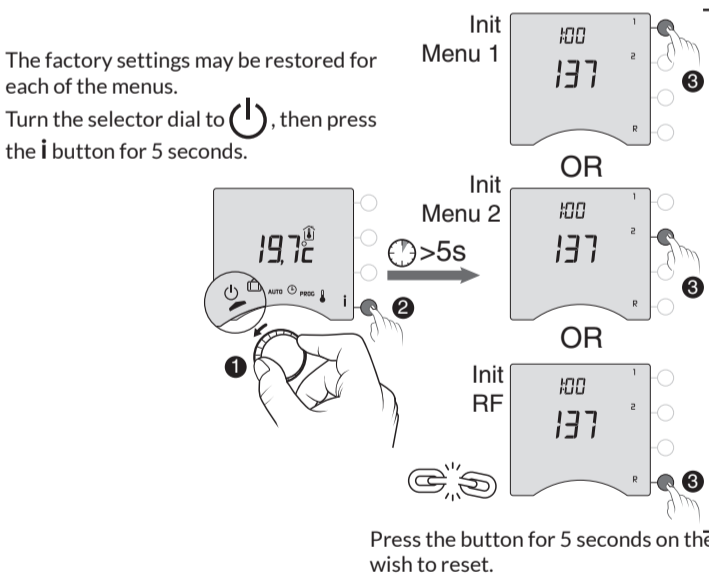

The products are delivered associated. To associate a new product or to associate again (after reset), proceed as described below:

- On the receiver, press the button for 3 seconds until the LED flashes. Release.
- On the transmitter, turn the selector dial to , then press the **i** button for 5 seconds.
- Press the R button, then fill in menu R-01 (see below) and/or move on to the next menu by pressing OK
- Rad menu Press the **i** button If «1» is displayed, the product has been associated.
- EXIT To exit the mode, turn the selector dial.

The receiver LED is no longer flashing. The receiver is associated with the transmitter

<b>R-01</b>	0	No
	1	Yes

Do you have one or more home automation radio products in your system? (e.g. Opening detector)